



Herefordshire  
Application for a premises licence  
Licensing Act 2003

For help contact  
licensing@herefordshire.gov.uk  
Telephone: 01432 261761

\* required information

**Section 1 of 21**

You can save the form at any time and resume it later. You do not need to be logged in when you resume.

System reference	<input type="text" value="Not Currently In Use"/>	This is the unique reference for this application generated by the system.
Your reference	<input type="text" value="50-20"/>	You can put what you want here to help you track applications if you make lots of them. It is passed to the authority.

Are you an agent acting on behalf of the applicant?

Yes       No

Put "no" if you are applying on your own behalf or on behalf of a business you own or work for.

**Applicant Details**

* First name	<input type="text" value="Claypitt Limited"/>	
* Family name	<input type="text" value="Claypitt Limited"/>	
* E-mail	<input type="text" value="info@redbankevents.co.uk"/>	
Main telephone number	<input type="text" value="07770 376548"/>	Include country code.
Other telephone number	<input type="text" value="07770 376548"/>	

Indicate here if the applicant would prefer not to be contacted by telephone

Is the applicant:

Applying as a business or organisation, including as a sole trader

Applying as an individual

A sole trader is a business owned by one person without any special legal structure. Applying as an individual means the applicant is applying so the applicant can be employed, or for some other personal reason, such as following a hobby.

**Applicant Business**

Is the applicant's business registered in the UK with Companies House?       Yes       No

Note: completing the Applicant Business section is optional in this form.

Registration number	<input type="text" value="10450044"/>	
Business name	<input type="text" value="Claypitt Ltd"/>	If the applicant's business is registered, use its registered name.
VAT number	<input type="text" value="-"/> <input type="text" value="None"/>	Put "none" if the applicant is not registered for VAT.
Legal status	<input type="text" value="Private Limited Company"/>	

**Continued from previous page...**

Applicant's position in the business

Home country

The country where the applicant's headquarters are.

**Registered Address**

Address registered with Companies House.

Building number or name

Street

District

City or town

County or administrative area

Postcode

Country

**Agent Details**

\* First name

\* Family name

\* E-mail

Main telephone number

Include country code.

Other telephone number

Indicate here if you would prefer not to be contacted by telephone

Are you:

An agent that is a business or organisation, including a sole trader

A sole trader is a business owned by one person without any special legal structure.

A private individual acting as an agent

**Agent Business**

Is your business registered in the UK with Companies House?  Yes  No

Note: completing the Applicant Business section is optional in this form.

Is your business registered outside the UK?  Yes  No

Business name

If your business is registered, use its registered name.

VAT number

Put "none" if you are not registered for VAT.

Legal status



**Continued from previous page...**

Your position in the business

Home country

The country where the headquarters of your business is located.

**Agent Business Address**

If you have one, this should be your official address - that is an address required of you by law for receiving communications.

Building number or name

Street

District

City or town

County or administrative area

Postcode

Country

**Section 2 of 21**

**PREMISES DETAILS**

I/we, as named in section 1, apply for a premises licence under section 17 of the Licensing Act 2003 for the premises described in section 2 below (the premises) and I/we are making this application to you as the relevant licensing authority in accordance with section 12 of the Licensing Act 2003.

**Premises Address**

Are you able to provide a postal address, OS map reference or description of the premises?

- Address     OS map reference     Description

**Postal Address Of Premises**

Building number or name

Street

District

City or town

County or administrative area

Postcode

Country

**Further Details**

Telephone number

Non-domestic rateable value of premises (£)

**Section 3 of 21****APPLICATION DETAILS**

In what capacity are you applying for the premises licence?

- An individual or individuals
- A limited company / limited liability partnership
- A partnership (other than limited liability)
- An unincorporated association
- Other (for example a statutory corporation)
- A recognised club
- A charity
- The proprietor of an educational establishment
- A health service body
- A person who is registered under part 2 of the Care Standards Act 2000 (c14) in respect of an independent hospital in Wales
- A person who is registered under Chapter 2 of Part 1 of the Health and Social Care Act 2008 in respect of the carrying on of a regulated activity (within the meaning of that Part) in an independent hospital in England
- The chief officer of police of a police force in England and Wales

**Confirm The Following**

- I am carrying on or proposing to carry on a business which involves the use of the premises for licensable activities
- I am making the application pursuant to a statutory function
- I am making the application pursuant to a function discharged by virtue of Her Majesty's prerogative

**Section 4 of 21****NON INDIVIDUAL APPLICANTS**

Provide name and registered address of applicant in full. Where appropriate give any registered number. In the case of a partnership or other joint venture (other than a body corporate), give the name and address of each party concerned.

**Non Individual Applicant's Name**

Name

**Details**

Registered number (where applicable)

Description of applicant (for example partnership, company, unincorporated association etc)



Continued from previous page...

Limited Company

**Address**

Building number or name

Street

District

City or town

County or administrative area

Postcode

Country

**Contact Details**

E-mail

Telephone number

Other telephone number

\* Date of birth

\* Nationality

Documents that demonstrate entitlement to work in the UK

**Section 5 of 21**

**OPERATING SCHEDULE**

When do you want the premises licence to start?  /  /   
dd mm yyyy

If you wish the licence to be valid only for a limited period, when do you want it to end  /  /   
dd mm yyyy

Provide a general description of the premises

For example the type of premises, its general situation and layout and any other information which could be relevant to the licensing objectives. Where your application includes off-supplies of alcohol and you intend to provide a place for consumption of these off- supplies you must include a description of where the place will be and its proximity to the premises.

The Red Barn is a business that provides barn wedding and event facilities on a working farm overlooking the River Wye. It is currently registered for Marriages and already operates under a succession of Temporary Event Notices. The volume of bookings has grown rapidly and has outgrown the current model of applying for TENs for individual events.

**Continued from previous page...**

If 5,000 or more people are expected to attend the premises at any one time, state the number expected to attend

**Section 6 of 21**

**PROVISION OF PLAYS**

See guidance on regulated entertainment

Will you be providing plays?

- Yes  No

**Section 7 of 21**

**PROVISION OF FILMS**

See guidance on regulated entertainment

Will you be providing films?

- Yes  No

**Standard Days And Timings**

MONDAY

Start

End

Start

End

Give timings in 24 hour clock. (e.g., 16:00) and only give details for the days of the week when you intend the premises to be used for the activity.

TUESDAY

Start

End

Start

End

WEDNESDAY

Start

End

Start

End

THURSDAY

Start

End

Start

End

FRIDAY

Start

End

Start

End

SATURDAY

Start

End

Start

End



*Continued from previous page...*

SUNDAY

Start

End

Start

End

Will the exhibition of films take place indoors or outdoors or both?

- Indoors       Outdoors       Both

Where taking place in a building or other structure tick as appropriate. Indoors may include a tent.

State type of activity to be authorised, if not already stated, and give relevant further details, for example (but not exclusively) whether or not music will be amplified or unamplified.

State any seasonal variations for the exhibition of film

For example (but not exclusively) where the activity will occur on additional days during the summer months.

Non standard timings. Where the premises will be used for the exhibition of film at different times from those listed in the column on the left, list below

For example (but not exclusively), where you wish the activity to go on longer on a particular day e.g. Christmas Eve.

**Section 8 of 21**

**PROVISION OF INDOOR SPORTING EVENTS**

See guidance on regulated entertainment

Will you be providing indoor sporting events?

- Yes       No

**Section 9 of 21**

**PROVISION OF BOXING OR WRESTLING ENTERTAINMENTS**

See guidance on regulated entertainment

Will you be providing boxing or wrestling entertainments?

- Yes       No

**Section 10 of 21**

**PROVISION OF LIVE MUSIC**

See guidance on regulated entertainment

Will you be providing live music?

Continued from previous page...

### Standard Days And Timings

MONDAY

Start

End

Start

End

Give timings in 24 hour clock.  
(e.g., 16:00) and only give details for the days  
of the week when you intend the premises  
to be used for the activity.

TUESDAY

Start

End

Start

End

WEDNESDAY

Start

End

Start

End

THURSDAY

Start

End

Start

End

FRIDAY

Start

End

Start

End

SATURDAY

Start

End

Start

End

SUNDAY

Start

End

Start

End

Will the performance of live music take place indoors or outdoors or both?

- Indoors       Outdoors       Both

Where taking place in a building or other  
structure tick as appropriate. Indoors may  
include a tent.

State type of activity to be authorised, if not already stated, and give relevant further details, for example (but not exclusively) whether or not music will be amplified or unamplified.

State any seasonal variations for the performance of live music

For example (but not exclusively) where the activity will occur on additional days during the summer months.



Continued from previous page...

Non-standard timings. Where the premises will be used for the performance of live music at different times from those listed in the column on the left, list below

For example (but not exclusively), where you wish the activity to go on longer on a particular day e.g. Christmas Eve.

**Section 11 of 21**

**PROVISION OF RECORDED MUSIC**

See guidance on regulated entertainment

Will you be providing recorded music?

- Yes                       No

**Standard Days And Timings**

MONDAY

Start

End

Start

End

TUESDAY

Start

End

Start

End

WEDNESDAY

Start

End

Start

End

THURSDAY

Start

End

Start

End

FRIDAY

Start

End

Start

End

SATURDAY

Start

End

Start

End

Give timings in 24 hour clock.  
(e.g., 16:00) and only give details for the days  
of the week when you intend the premises  
to be used for the activity.

Continued from previous page...

SUNDAY

Start

End

Start

End

Will the playing of recorded music take place indoors or outdoors or both?

- Indoors       Outdoors       Both

Where taking place in a building or other structure tick as appropriate. Indoors may include a tent.

State type of activity to be authorised, if not already stated, and give relevant further details, for example (but not exclusively) whether or not music will be amplified or unamplified.

State any seasonal variations for playing recorded music

For example (but not exclusively) where the activity will occur on additional days during the summer months.

Non-standard timings. Where the premises will be used for the playing of recorded music at different times from those listed in the column on the left, list below

For example (but not exclusively), where you wish the activity to go on longer on a particular day e.g. Christmas Eve.

**Section 12 of 21**

**PROVISION OF PERFORMANCES OF DANCE**

See guidance on regulated entertainment

Will you be providing performances of dance?

- Yes       No

**Section 13 of 21**

**PROVISION OF ANYTHING OF A SIMILAR DESCRIPTION TO LIVE MUSIC, RECORDED MUSIC OR PERFORMANCES OF DANCE**

See guidance on regulated entertainment

Will you be providing anything similar to live music, recorded music or performances of dance?

- Yes       No

**Section 14 of 21**

**LATE NIGHT REFRESHMENT**

Will you be providing late night refreshment?



Continued from previous page...

**Standard Days And Timings**

MONDAY

Start

End

Start

End

Give timings in 24 hour clock.  
(e.g., 16:00) and only give details for the days  
of the week when you intend the premises  
to be used for the activity.

TUESDAY

Start

End

Start

End

WEDNESDAY

Start

End

Start

End

THURSDAY

Start

End

Start

End

FRIDAY

Start

End

Start

End

SATURDAY

Start

End

Start

End

SUNDAY

Start

End

Start

End

Will the provision of late night refreshment take place indoors or outdoors or both?

- Indoors       Outdoors       Both

Where taking place in a building or other structure tick as appropriate. Indoors may include a tent.

State type of activity to be authorised, if not already stated, and give relevant further details, for example (but not exclusively) whether or not music will be amplified or unamplified.

State any seasonal variations

*Continued from previous page...*

For example (but not exclusively) where the activity will occur on additional days during the summer months.

Non-standard timings. Where the premises will be used for the supply of late night refreshments at different times from those listed in the column on the left, list below

For example (but not exclusively), where you wish the activity to go on longer on a particular day e.g. Christmas Eve.

## Section 15 of 21

### SUPPLY OF ALCOHOL

Will you be selling or supplying alcohol?

Yes  No

#### Standard Days And Timings

MONDAY

Start

End

Start

End

TUESDAY

Start

End

Start

End

WEDNESDAY

Start

End

Start

End

THURSDAY

Start

End

Start

End

FRIDAY

Start

End

Start

End

SATURDAY

Start

End

Start

End

Give timings in 24 hour clock.  
(e.g., 16:00) and only give details for the days  
of the week when you intend the premises  
to be used for the activity.



*Continued from previous page...*

SUNDAY

Start

End

Start

End

Will the sale of alcohol be for consumption:

- On the premises       Off the premises       Both

If the sale of alcohol is for consumption on the premises select on, if the sale of alcohol is for consumption away from the premises select off. If the sale of alcohol is for consumption on the premises and away from the premises select both.

State any seasonal variations

For example (but not exclusively) where the activity will occur on additional days during the summer months.

None

Non-standard timings. Where the premises will be used for the supply of alcohol at different times from those listed in the column on the left, list below

For example (but not exclusively), where you wish the activity to go on longer on a particular day e.g. Christmas Eve.

State the name and details of the individual whom you wish to specify on the licence as premises supervisor

**Name**

First name

Family name

Date of birth

Continued from previous page...

**Enter the contact's address**

Building number or name

Street

District

City or town

County or administrative area

Postcode

Country

Personal Licence number  
(if known)

Issuing licensing authority  
(if known)

Herefordshire

**PROPOSED DESIGNATED PREMISES SUPERVISOR CONSENT**

How will the consent form of the proposed designated premises supervisor be supplied to the authority?

- Electronically, by the proposed designated premises supervisor
- As an attachment to this application

Reference number for consent form (if known)

50-20

If the consent form is already submitted, ask the proposed designated premises supervisor for its 'system reference' or 'your reference'.

**Section 16 of 21**

**ADULT ENTERTAINMENT**

Highlight any adult entertainment or services, activities, or other entertainment or matters ancillary to the use of the premises that may give rise to concern in respect of children

Give information about anything intended to occur at the premises or ancillary to the use of the premises which may give rise to concern in respect of children, regardless of whether you intend children to have access to the premises, for example (but not exclusively) nudity or semi-nudity, films for restricted age groups etc gambling machines etc.

None

**Section 17 of 21**

**HOURS PREMISES ARE OPEN TO THE PUBLIC**

**Standard Days And Timings**

MONDAY

Start 08:00

End 24:00

Start

End

Give timings in 24 hour clock. (e.g., 16:00) and only give details for the days of the week when you intend the premises to be used for the activity.

Continued from previous page...

TUESDAY

Start  End

Start  End

WEDNESDAY

Start  End

Start  End

THURSDAY

Start  End

Start  End

FRIDAY

Start  End

Start  End

SATURDAY

Start  End

Start  End

SUNDAY

Start  End

Start  End

State any seasonal variations

For example (but not exclusively) where the activity will occur on additional days during the summer months.

None

Non standard timings. Where you intend to use the premises to be open to the members and guests at different times from those listed in the column on the left, list below

For example (but not exclusively), where you wish the activity to go on longer on a particular day e.g. Christmas Eve.

**Section 18 of 21**

**LICENSING OBJECTIVES**

Describe the steps you intend to take to promote the four licensing objectives:

a) General – all four licensing objectives (b,c,d,e)



**Continued from previous page...**

List here steps you will take to promote all four licensing objectives together.

The Red Barn is an established business based within its own grounds at the Whitehall Farm - itself a small village in Herefordshire at the side of the River Wye. It is going from strength to strength and as such, this application for a premises licence is to allow the both on sale and off-sales to persons using the facility for recreation and leisure - primarily weddings. These activities will take place within the existing footprint of its grounds. We believe this will allow the business to grow and will provide a service to the wider customer base which they are attracting.

As part of this application process, we recognise that the premises is within a comparatively isolated, rural and stand alone location - and is unlikely to have any large and/or adverse effect on neighbouring properties. We have liaised with West Mercia Police and have explained to them what our intentions are, and when making this application have taken into account their suggestions i.e. both the requirements of the Licensing Act 2003 and the Herefordshire Council's licensing policy.

**b) The prevention of crime and disorder**

An incident log must be kept at the premises. Incident log records will be retained for a period of 12 months from the date it occurred. It will be made immediately available on request to an 'authorised person' (as defined by Section 13 of the Licensing Act 2003), an authorised Trading Standards Officer or the Police, and must record the following:

- (a) all crimes reported to the premises (where relevant to the licensing objectives)
- (b) all ejections of patrons
- (c) any complaints received (where relevant to the licensing objectives)
- (d) any incidents of disorder
- (e) any refusal of the sale of alcohol
- (f) any visit by a relevant authority or emergency services, noting time, date & purpose and those officials by name.

All staff engaged in the sale of alcohol to be trained in Responsible Alcohol Retailing to the minimum standard of BIIAB1 or any other training package equivalent to BIIAB level within one month of the date that this condition appears on this licence. (Where there are existing staff this training shall be completed within 3 months of the date that this condition first appears on the licence). Training records shall be kept on the premises, and shall be produced to the Police or an Authorised Person' (as defined by s13 of the Licensing Act 2003) or an authorised Trading Standards Officer of Herefordshire Council on demand.

**c) Public safety**

First Aid: A First Aid Kit for 21-50 people shall be kept fully stocked at the premises and kept behind the bar. Such kit shall contain:

- 1 x Guidance Leaflet,
- 60 x Washproof Plasters,
- 6 x Eye Pads with Bandage,
- 8 x Triangular Bandages,
- 12 x Safety Pins,
- 16 x Assorted Sterile Dressings,
- 20 Moist Wipes,
- 3 Pairs Disposable Gloves.

Electrical & Gas Installations: All electrical wiring and distribution systems shall be tested at least once a year and signed off by a competent person whose name is shown within the Local Authority Building Control Part P Competent Persons Register (<http://www.competentperson.co.uk/search.asp>). The sign off certificate shall be produced to an 'Authorised Person' (as defined by Section 13 of the Licensing Act 2003) or Police on demand.

Any and all gas appliances (except cellar gas) used in the premises must be tested at least once a year and signed off by a competent person whose name appears within the current Gas Safety register (GSR). The sign off certificate shall be produced to an 'Authorised Person' (as defined by Section 13 of the Licensing Act 2003) or Police on demand.

*Continued from previous page...*

d) The prevention of public nuisance

Prominent, clear and legible signage (in not less than 32 font bold) shall be displayed at all exits to the premises requesting the public to respect the needs of local residents and/or to leave the premises and the area quickly and quietly, as appropriate.

e) The protection of children from harm

The premises shall operate a Challenge 25 Policy. Such policy shall be written down and kept at the premises. The policy shall be produced on demand of the Police or an 'authorised person' (as defined by Section 13 of the Licensing Act 2003) or an authorised Trading Standards Officer the Local Authority/Council. Prominent, clear and legible signage (in not less than 32 font bold) shall also be displayed at all entrances to the premises as well as at, at least one location behind any counter advertising the scheme operated.

A written or electronic register of refusals will be kept including a description of the people who have been unable to provide required identification to prove their age. Such records shall be kept for a period of 12 months. It will be collected and reviewed on a weekly basis by the Designated Premises Supervisor and produced to the police or an 'authorised person' (as defined by Section 13 of the Licensing Act 2003) or an authorised Trading Standards Officer of Herefordshire Council on demand.

**Section 19 of 21**

**NOTES ON DEMONSTRATING ENTITLEMENT TO WORK IN THE UK**



*Continued from previous page...*

**Entitlement to work/immigration status for individual applicants and applications from partnerships which are not limited liability partnerships:**

A licence may not be held by an individual or an individual in a partnership who is resident in the UK who:

- does not have the right to live and work in the UK; or
- is subject to a condition preventing him or her from doing work relating to the carrying on of a licensable activity.

Any premises licence issued in respect of an application made on or after 6 April 2017 will become invalid if the holder ceases to be entitled to work in the UK.

Applicants must demonstrate that they have an entitlement to work in the UK and are not subject to a condition preventing them from doing work relating to the carrying on of a licensable activity. They do this by providing with this application copies or scanned copies of the following documents (which do not need to be certified).

**Documents which demonstrate entitlement to work in the UK**

- An expired or current passport showing the holder, or a person named in the passport as the child of the holder, is a British citizen or a citizen of the UK and Colonies having the right of abode in the UK [please see note below about which sections of the passport to copy].
- An expired or current passport or national identity card showing the holder, or a person named in the passport as the child of the holder, is a national of a European Economic Area country or Switzerland.
- A Registration Certificate or document certifying permanent residence issued by the Home Office to a national of a European Economic Area country or Switzerland.
- A Permanent Residence Card issued by the Home Office to the family member of a national of a European Economic Area country or Switzerland.
- A **current** Biometric Immigration Document (Biometric Residence Permit) issued by the Home Office to the holder indicating that the person named is allowed to stay indefinitely in the UK, or has no time limit on their stay in the UK.
- A **current** passport endorsed to show that the holder is exempt from immigration control, is allowed to stay indefinitely in the UK, has the right of abode in the UK, or has no time limit on their stay in the UK.
- A **current** Immigration Status Document issued by the Home Office to the holder with an endorsement indicating that the named person is allowed to stay indefinitely in the UK or has no time limit on their stay in the UK, **when produced in combination with** an official document giving the person's permanent National Insurance number and their name issued by a Government agency or a previous employer.
- A **full** birth or adoption certificate issued in the UK which includes the name(s) of at least one of the holder's parents or adoptive parents, **when produced in combination with** an official document giving the person's permanent National Insurance number and their name issued by a Government agency or a previous employer.
- A birth or adoption certificate issued in the Channel Islands, the Isle of Man or Ireland **when produced in combination with** an official document giving the person's permanent National Insurance number and their name issued by a Government agency or a previous employer.
- A certificate of registration or naturalisation as a British citizen, **when produced in combination with** an official document giving the person's permanent National Insurance number and their name issued by a Government agency or a previous employer.
- A **current** passport endorsed to show that the holder is allowed to stay in the UK and is currently allowed to work and is not subject to a condition preventing the holder from doing work relating to the carrying on of a licensable activity.



*Continued from previous page...*

- A **current** Biometric Immigration Document (Biometric Residence Permit) issued by the Home Office to the holder which indicates that the named person can currently stay in the UK and is allowed to work relation to the carrying on of a licensable activity.
- A **current** Residence Card issued by the Home Office to a person who is not a national of a European Economic Area state or Switzerland but who is a family member of such a national or who has derivative rights or residence.
- A **current** Immigration Status Document containing a photograph issued by the Home Office to the holder with an endorsement indicating that the named person may stay in the UK, and is allowed to work and is not subject to a condition preventing the holder from doing work relating to the carrying on of a licensable activity **when produced in combination with** an official document giving the person's permanent National Insurance number and their name issued by a Government agency or a previous employer.
- A Certificate of Application, **less than 6 months old**, issued by the Home Office under regulation 17(3) or 18A (2) of the Immigration (European Economic Area) Regulations 2006, to a person who is not a national of a European Economic Area state or Switzerland but who is a family member of such a national or who has derivative rights of residence.
- Reasonable evidence that the person has an outstanding application to vary their permission to be in the UK with the Home Office such as the Home Office acknowledgement letter or proof of postage evidence, or reasonable evidence that the person has an appeal or administrative review pending on an immigration decision, such as an appeal or administrative review reference number.
- Reasonable evidence that a person who is not a national of a European Economic Area state or Switzerland but who is a family member of such a national or who has derivative rights of residence in exercising treaty rights in the UK including:-
  - evidence of the applicant's own identity – such as a passport,
  - evidence of their relationship with the European Economic Area family member – e.g. a marriage certificate, civil partnership certificate or birth certificate, and
  - evidence that the European Economic Area national has a right of permanent residence in the UK or is one of the following if they have been in the UK for more than 3 months:
    - (i) working e.g. employment contract, wage slips, letter from the employer,
    - (ii) self-employed e.g. contracts, invoices, or audited accounts with a bank,
    - (iii) studying e.g. letter from the school, college or university and evidence of sufficient funds; or
    - (iv) self-sufficient e.g. bank statements.

Family members of European Economic Area nationals who are studying or financially independent must also provide evidence that the European Economic Area national and any family members hold comprehensive sickness insurance in the UK. This can include a private medical insurance policy, an EHIC card or an S1, S2 or S3 form.

**Original documents must not be sent to licensing authorities.** If the document copied is a passport, a copy of the following pages should be provided:-

- (i) any page containing the holder's personal details including nationality;
- (ii) any page containing the holder's photograph;
- (iii) any page containing the holder's signature;
- (iv) any page containing the date of expiry; and
- (v) any page containing information indicating the holder has permission to enter or remain in the UK and is permitted to work.

If the document is not a passport, a copy of the whole document should be provided.

Your right to work will be checked as part of your licensing application and this could involve us checking your immigration status with the Home Office. We may otherwise share information with the Home Office. Your licence application will not be determined until you have complied with this guidance.

## Section 20 of 21

### NOTES ON REGULATED ENTERTAINMENT



*Continued from previous page...*

In terms of specific **regulated entertainments** please note that:

- Plays: no licence is required for performances between 08:00 and 23.00 on any day, provided that the audience does not exceed 500.
- Films: no licence is required for 'not-for-profit' film exhibition held in community premises between 08.00 and 23.00 on any day provided that the audience does not exceed 500 and the organiser (a) gets consent to the screening from a person who is responsible for the premises; and (b) ensures that each such screening abides by age classification ratings.
- Indoor sporting events: no licence is required for performances between 08.00 and 23.00 on any day, provided that the audience does not exceed 1000.
- Boxing or Wrestling Entertainment: no licence is required for a contest, exhibition or display of Greco-Roman wrestling, or freestyle wrestling between 08.00 and 23.00 on any day, provided that the audience does not exceed 1000. Combined fighting sports – defined as a contest, exhibition or display which combines boxing or wrestling with one or more martial arts – are licensable as a boxing or wrestling entertainment rather than an indoor sporting event.
- Live music: no licence permission is required for:
  - o a performance of unamplified live music between 08.00 and 23.00 on any day, on any premises.
  - o a performance of amplified live music between 08.00 and 23.00 on any day on premises authorised to sell alcohol for consumption on those premises, provided that the audience does not exceed 500.
  - o a performance of amplified live music between 08.00 and 23.00 on any day, in a workplace that is not licensed to sell alcohol on those premises, provided that the audience does not exceed 500.
  - o a performance of amplified live music between 08.00 and 23.00 on any day, in a church hall, village hall, community hall, or other similar community premises, that is not licensed by a premises licence to sell alcohol, provided that (a) the audience does not exceed 500, and (b) the organiser gets consent for the performance from a person who is responsible for the premises.
  - o a performance of amplified live music between 08.00 and 23.00 on any day, at the non-residential premises of (i) a local authority, or (ii) a school, or (iii) a hospital, provided that (a) the audience does not exceed 500, and (b) the organiser gets consent for the performance on the relevant premises from: (i) the local authority concerned, or (ii) the school or (iii) the health care provider for the hospital.
- Recorded Music: no licence permission is required for:
  - o any playing of recorded music between 08.00 and 23.00 on any day on premises authorised to sell alcohol for consumption on those premises, provided that the audience does not exceed 500.
  - o any playing of recorded music between 08.00 and 23.00 on any day, in a church hall, village hall, community hall, or other similar community premises, that is not licensed by a premises licence to sell alcohol, provided that (a) the audience does not exceed 500, and (b) the organiser gets consent for the performance from a person who is responsible for the premises.
  - o any playing of recorded music between 08.00 and 23.00 on any day, at the non-residential premises of (i) a local authority, or (ii) a school, or (iii) a hospital, provided that (a) the audience does not exceed 500, and (b) the organiser gets consent for the performance on the relevant premises from: (i) the local authority concerned, or (ii) the school proprietor or (iii) the health care provider for the hospital.



**Continued from previous page...**

- Dance: no licence is required for performances between 08.00 and 23.00 on any day, provided that the audience does not exceed 500. However, a performance which amounts to adult entertainment remains licensable.
- Cross activity exemptions: no licence is required between 08.00 and 23.00 on any day, with no limit on audience size for:
  - o any entertainment taking place on the premises of the local authority where the entertainment is provided by or on behalf of the local authority;
  - o any entertainment taking place on the hospital premises of the health care provider where the entertainment is provided by or on behalf of the health care provider;
  - o any entertainment taking place on the premises of the school where the entertainment is provided by or on behalf of the school proprietor; and
  - o any entertainment (excluding films and a boxing or wrestling entertainment) taking place at a travelling circus, provided that (a) it takes place within a moveable structure that accommodates the audience, and (b) that the travelling circus has not been located on the same site for more than 28 consecutive days.

**Section 21 of 21**

**PAYMENT DETAILS**

This fee must be paid to the authority. If you complete the application online, you must pay it by debit or credit card.

Premises Licence Fees are determined by the non-domestic rateable value of the premises.

To find out a premises non domestic rateable value go to the Valuation Office Agency site at [http://www.voa.gov.uk/business\\_rates/index.htm](http://www.voa.gov.uk/business_rates/index.htm)

Band A - No RV to £4300 £100.00

Band B - £4301 to £33000 £190.00

Band C - £33001 to £87000 £315.00

Band D - £87001 to £125000 £450.00\*

Band E - £125001 and over £635.00\*

\*If the premises rateable value is in Bands D or E and the premises is primarily used for the consumption of alcohol on the premises then you are required to pay a higher fee.

Band D - £87001 to £125000 £900.00

Band E - £125001 and over £1,905.00

There is an exemption from the payment of fees in relation to the provision of regulated entertainment at church halls, chapel halls or premises of a similar nature, village halls, parish or community halls, or other premises of a similar nature. The costs associated with these licences will be met by central Government. If, however, the licence also authorises the use of the premises for the supply of alcohol or the provision of late night refreshment, a fee will be required.

Schools and sixth form colleges are exempt from the fees associated with the authorisation of regulated entertainment where the entertainment is provided by and at the school or college and for the purposes of the school or college.

If you operate a large event you are subject to ADDITIONAL fees based upon the number in attendance at any one time.

Capacity 5000-9999 £1,000.00

Capacity 10000 -14999 £2,000.00

Capacity 15000-19999 £4,000.00

Capacity 20000-29999 £8,000.00

Capacity 30000-39999 £16,000.00

Capacity 40000-49999 £24,000.00

Capacity 50000-59999 £32,000.00

Capacity 60000-69999 £40,000.00

Capacity 70000-79999 £48,000.00

Capacity 80000-89999 £56,000.00

Capacity 90000 and over £64,000.00

\* Fee amount (£)

190.00

**DECLARATION**

1



**Continued from previous page...**

\* I/we understand it is an offence, liable on conviction to a fine up to level 5 on the standard scale, under section 158 of the licensing act 2003, to make a false statement in or in connection with this application.

[Applicable to individual applicants only, including those in a partnership which is not a limited liability partnership] I understand I am not entitled to be issued with a licence if I do not have the entitlement to live and work in the UK (or if I am subject to a condition preventing me from doing work relating to the carrying on of a licensable activity) and that my licence will become invalid if I cease to be entitled to live and work in the UK (please read guidance note 15).

The DPS named in this application form is entitled to work in the UK (and is not subject to conditions preventing him or her from doing work relating to a licensable activity) and I have seen a copy of his or her proof of entitlement to work, if appropriate (please see note 15)

Ticking this box indicates you have read and understood the above declaration

This section should be completed by the applicant, unless you answered "Yes" to the question "Are you an agent acting on behalf of the applicant?"

\* Full name

\* Capacity

\* Date  /  /   
dd mm yyyy

Once you're finished you need to do the following:

1. Save this form to your computer by clicking file/save as...
2. Go back to <https://www.gov.uk/apply-for-a-licence/premises-licence/herefordshire/apply-1> to upload this file and continue with your application.

Don't forget to make sure you have all your supporting documentation to hand.

**IT IS AN OFFENCE LIABLE TO SUMMARY CONVICTION TO A FINE OF ANY AMOUNT UNDER SECTION 158 OF THE LICENSING ACT 2003, TO MAKE A FALSE STATEMENT IN OR IN CONNECTION WITH THIS APPLICATION**

**IT IS AN OFFENCE UNDER SECTION 24B OF THE IMMIGRATION ACT 1971 FOR A PERSON TO WORK WHEN THEY KNOW, OR HAVE REASONABLE CAUSE TO BELIEVE, THAT THEY ARE DISQUALIFIED FROM DOING SO BY REASON OF THEIR IMMIGRATION STATUS. THOSE WHO EMPLOY AN ADULT WITHOUT LEAVE OR WHO IS SUBJECT TO CONDITIONS AS TO EMPLOYMENT WILL BE LIABLE TO A CIVIL PENALTY UNDER SECTION 15 OF THE IMMIGRATION, ASYLUM AND NATIONALITY ACT 2006 AND PURSUANT TO SECTION 21 OF THE SAME ACT, WILL BE COMMITTING AN OFFENCE WHERE THEY DO SO IN THE KNOWLEDGE, OR WITH REASONABLE CAUSE TO BELIEVE, THAT THE EMPLOYEE IS DISQUALIFIED**

**OFFICE USE ONLY**

Applicant reference number	<input type="text" value="50-20"/>
Fee paid	<input type="text"/>
Payment provider reference	<input type="text"/>
ELMS Payment Reference	<input type="text"/>
Payment status	<input type="text"/>
Payment authorisation code	<input type="text"/>
Payment authorisation date	<input type="text"/>
Date and time submitted	<input type="text"/>
Approval deadline	<input type="text"/>
Error message	<input type="text"/>
Is Digitally signed	<input type="checkbox"/>

[1](#) [2](#) [3](#) [4](#) [5](#) [6](#) [7](#) [8](#) [9](#) [10](#) [11](#) [12](#) [13](#) [14](#) [15](#) [16](#) [17](#) [18](#) [19](#) [20](#) [21](#) [Next >](#)

**Consent of individual to being specified as premises supervisor**

James Andrew Jonathon ROGERS

I

-----  
*[full name of prospective premises supervisor]*

of



-----  
*[home address of prospective premises supervisor]*

hereby confirm that I give my consent to be specified as the designated premises supervisor in relation to the application for

Grant of a Premises Licence

-----  
*[type of application]*

by

Claypitt Ltd

-----  
*[name of applicant]*

relating to a premises licence

tba

-----  
*[number of existing licence, if any]*

for

Redbank Barn  
New Groves Lane  
Hampton Bishop  
HEREFORD  
HR1 9LD

-----  
*[name and address of premises to which the application relates]*



and any premises licence to be granted or varied in respect of this application made by

Claypitt Ltd

-----  
*[name of applicant]*

concerning the supply of alcohol at

Redbank Barn  
New Groves Lane  
Hampton Bishop  
HEREFORD  
HR1 9LD

-----  
*[name and address of premises to which application relates]*

I also confirm that I am applying for, intend to apply for or currently hold a personal licence, details of which I set out below.

Personal licence number



-----  
*[insert personal licence number, if any]*

Personal licence issuing authority

Herefordshire Council

-----  
*[insert name and address and telephone number of personal licence issuing authority, if any]*

Signed

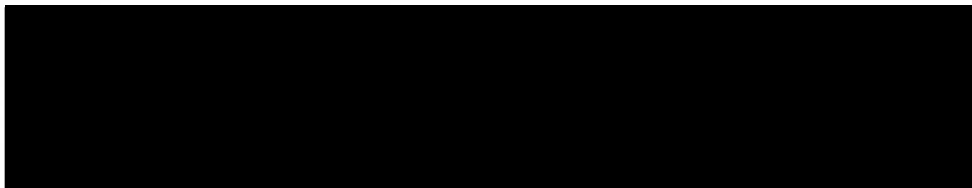

Name (please print)

James Andrew Jonathon ROGERS

Date

-----  
9<sup>th</sup> June 2020

# Redbank Barn, New Groves Lane, Hampton Bishop, Herefordshire. HR19LD

Extinguisher Point Water    Licensable Activity    Consumption Area

Scale 1:1000

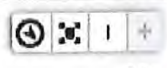





Leaflet | Open copyright and database rights (2020) Ordnance Survey (100024768)



Redbank Barn, New Groves Lane,  
Hampton Bishop, Herefordshire, HR19LD



KEY

- Emergency Lighting 
- Fire Call Point & Beacon 
- Fire Extinguisher Foam 
- Fire Extinguisher Powder 

Scale 1:100

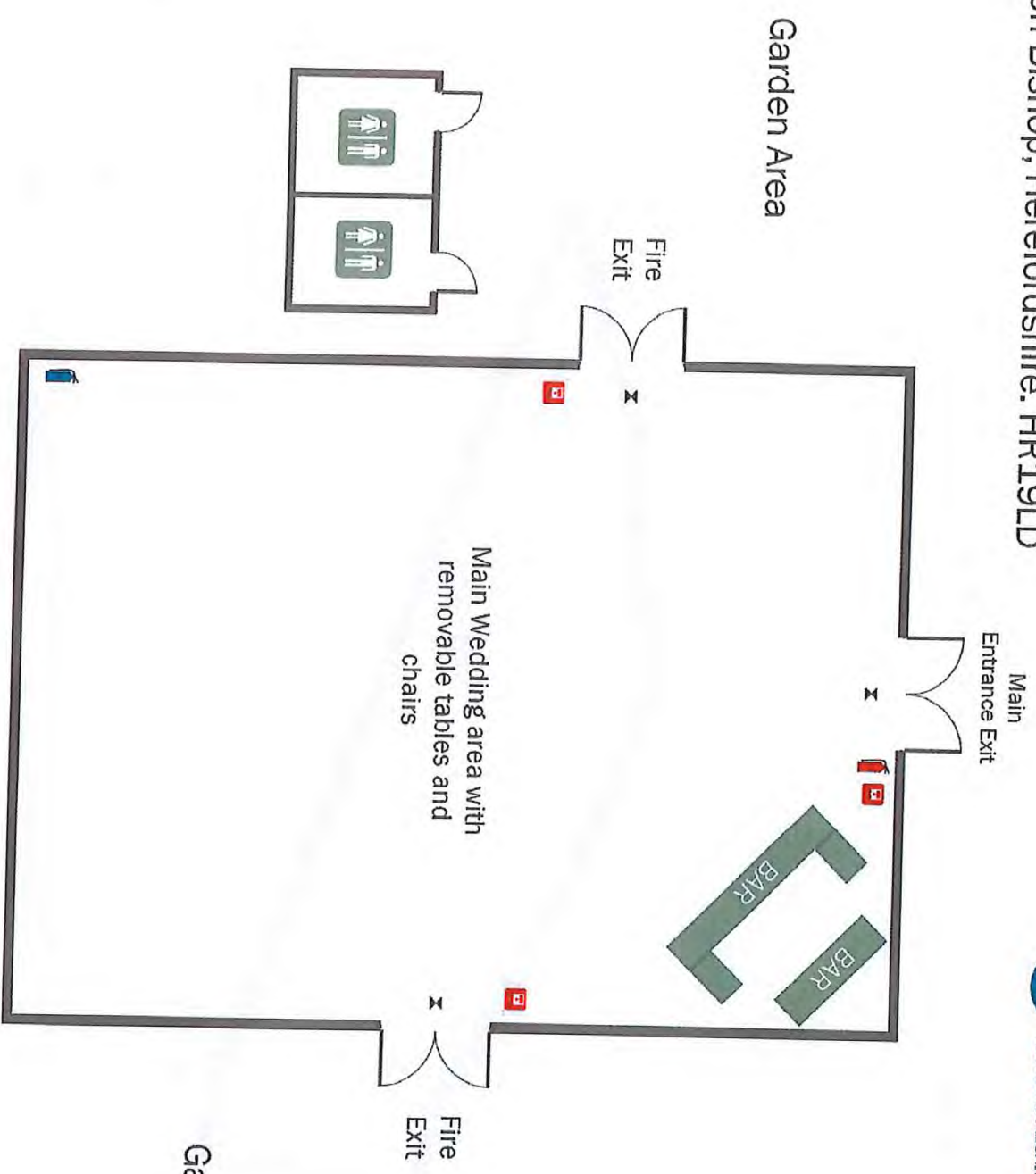

Garden Area